



DELTA
HOTELS

MARRIOTT

CHELtenham CHASE

CAPACITIES

Meeting Room	Dimensions (m) L x W x H	Floor	Theatre	Cabaret	Classroom	Boardroom	Banquet	U-Shape	Dinner Dance
Buckholt Suite	19.5 x 15.6 x 2.9	G	300	160	120	80	220	60	220
Buckholt 1	19.5 x 7.8 x 2.9	G	120	64	75	40	60	40	60
Buckholt 2	19.5 x 7.8 x 2.9	G	120	64	75	40	60	40	60
Abbey & Avon Suite	16.2 x 7.3 x 2.7	1	80	56	50	40	70	30	70
Abbey Suite	8.1 x 7.3 x 2.7	1	50	32	18	24	40	24	40
Avon Suite	8.1 x 7.3 x 2.7	1	50	32	18	24	40	24	40
Cathedral Suite	11.1 x 6.9 x 2.7	1	60	40	50	24	60	24	60
Blenheim Suite	7.7 x 7.3 x 2.7	1	30	24	16	20	30	20	30
Meteor Suite	7.7 x 7.3 x 2.7	1	30	24	16	20	30	20	30
Gladiator Suite	6.9 x 5.2 x 2.7	1	20	0	14	16	10	14	n/a
Javelin Suite	7.7 x 3.7 x 2.7	1	12	n/a	n/a	10	n/a	n/a	n/a
Merlin Suite	7.7 x 3.7 x 2.7	1	12	n/a	n/a	10	n/a	n/a	n/a

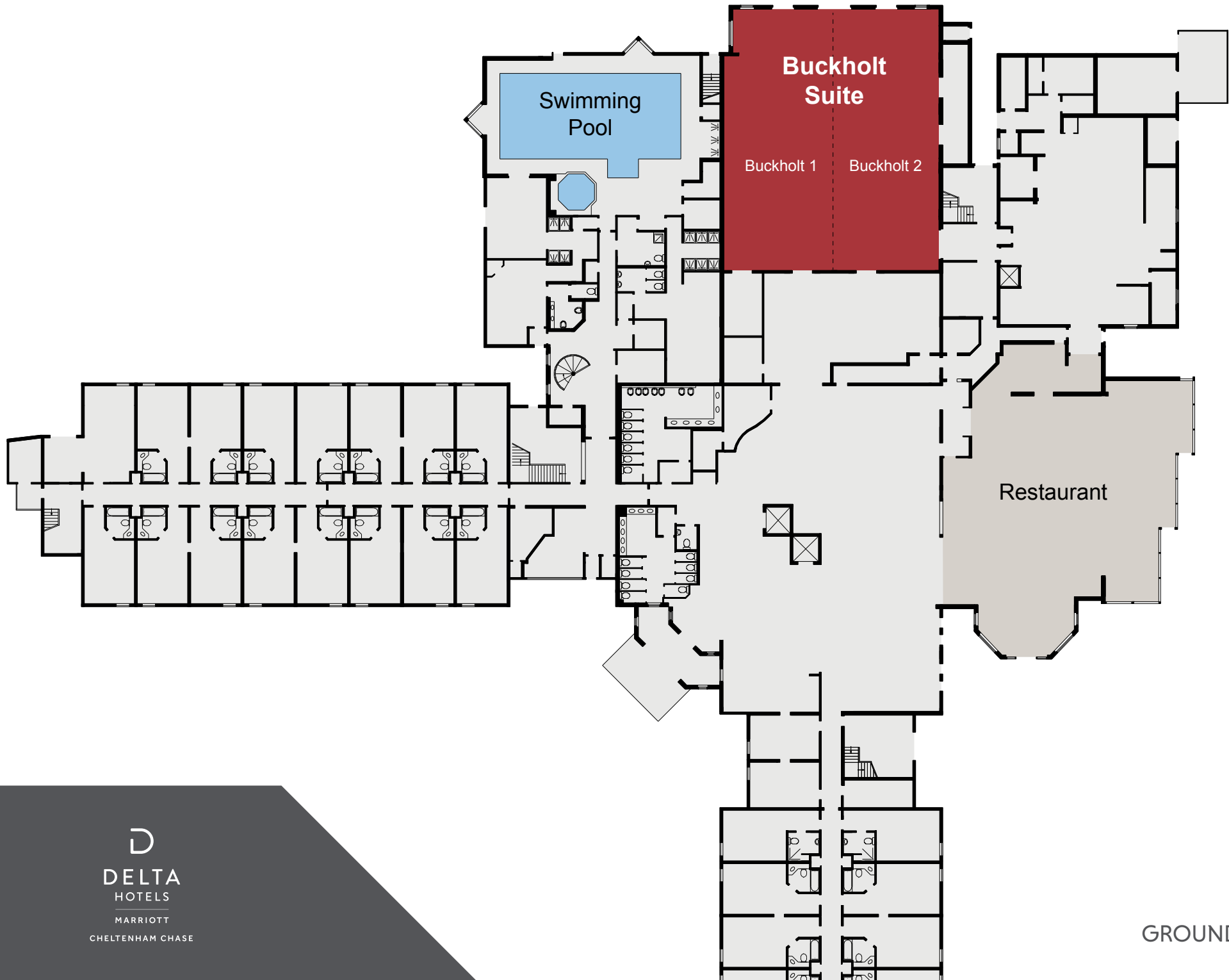



KEY

- Single 13amp Power Point
- Double 13amp Power Point
- ▶ Natural Light
- ☎ Telephone Socket
- ♿ Wheelchair Access
- ⋈ Partition Wall

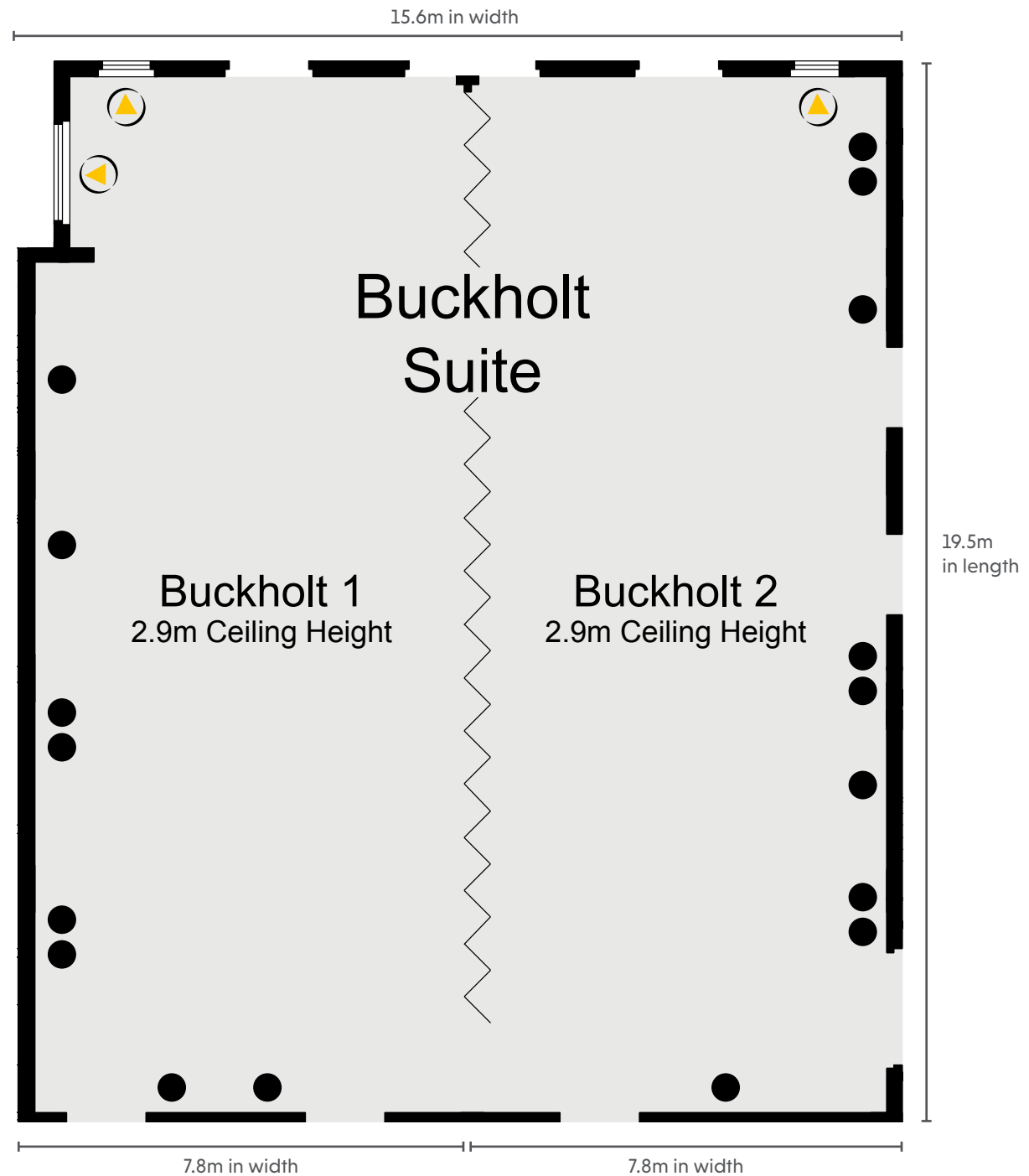

KEY

- Single 13amp Power Point
- Double 13amp Power Point
- ▶ Natural Light
- ☎ Telephone Socket
- ♿ Wheelchair Access
- ⋈ Partition Wall

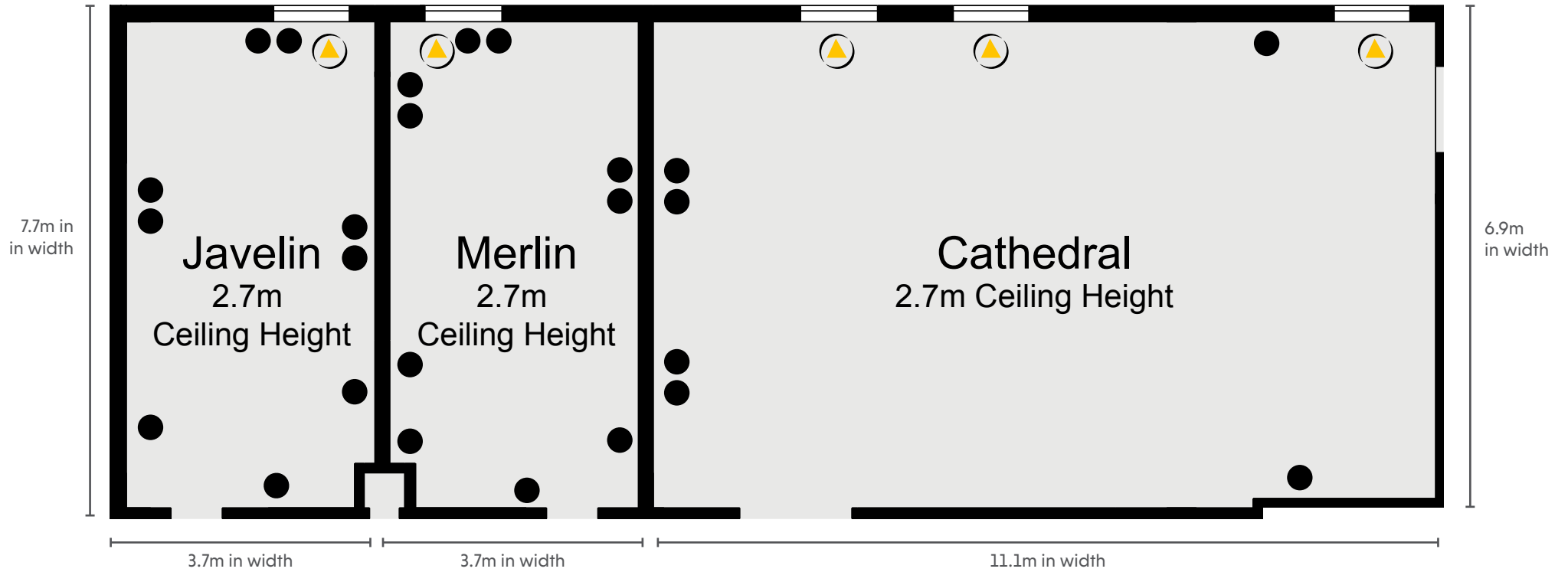

KEY

- Single 13amp Power Point
- Double 13amp Power Point
- ▶ Natural Light
- ☎ Telephone Socket
- ♿ Wheelchair Access
- ⋈ Partition Wall

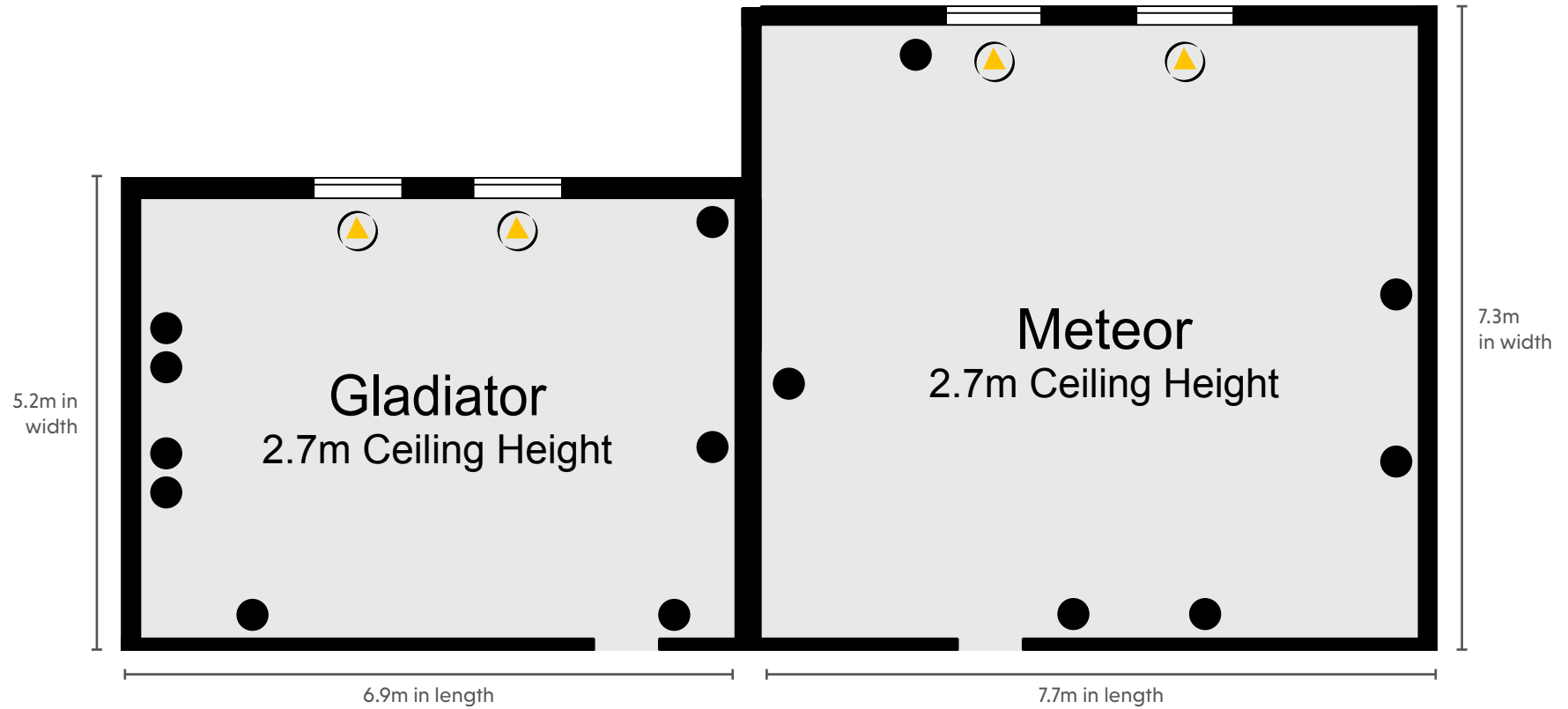

KEY

- Single 13amp Power Point
- Double 13amp Power Point
- ▶ Natural Light
- ☎ Telephone Socket
- ♿ Wheelchair Access
- ⚡ Partition Wall

